

aquamox

Installation Instructions

Wall Niche

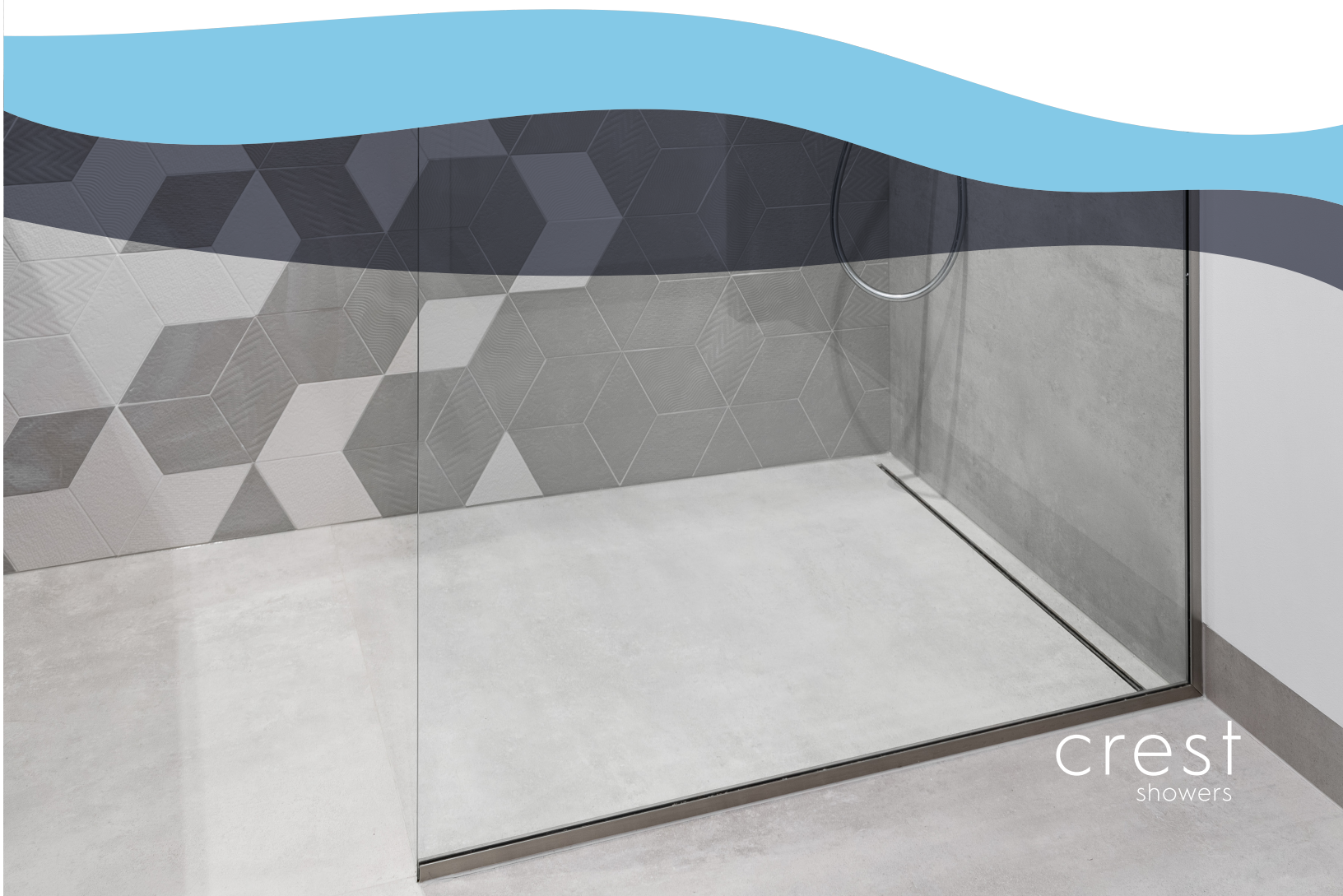

crest
showers

Before You Start

Tools Required

- Caulking Gun
- Power Drill

! **DO NOT** use solvent based glue (we recomend using Aquamox AP1070)



Preperation

- Ensure that the work area and framing surfaces are clean and free of dust to ensure adhesion

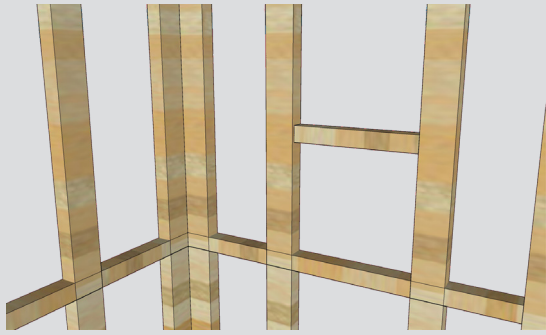

Step 1:
Measure the niche and add framing or noggings around the flange area of the niche in the wall frame.

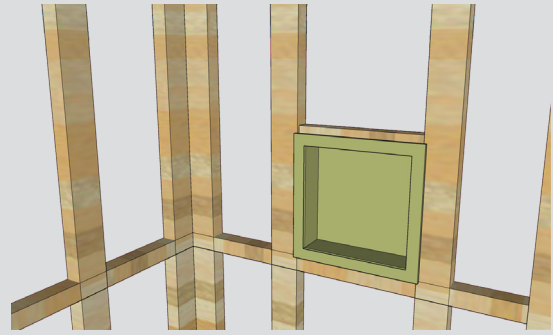

Step 2:
Dry fit the niche into the framed cavity to check for size.

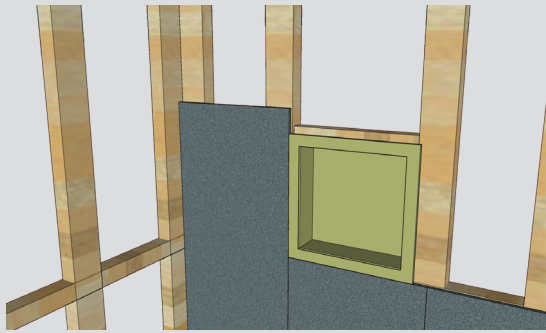

Step 3:
Install wallboard to finish flush with outside edge of wall niche flange according to industry standards. (You may need to pack out the wall niche to meet flush with the thickness of the wall lining).

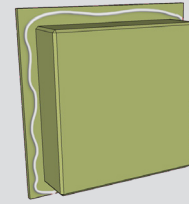

Step 4:
Apply a bead of adhesive onto the back of the flange and press onto the framework.

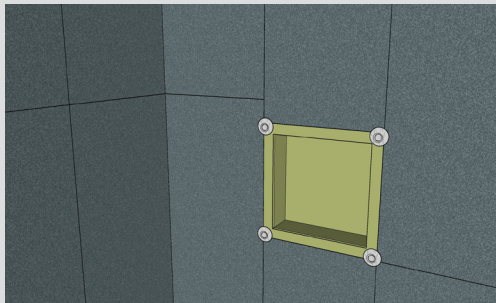

Step 5:
Pre-Drill then, Screw in a minimum of 4 small countersunk stainless steel screws and washers through the flange to hold firm. Ensure you screw through the wall niche into wall framing through the flange area only.

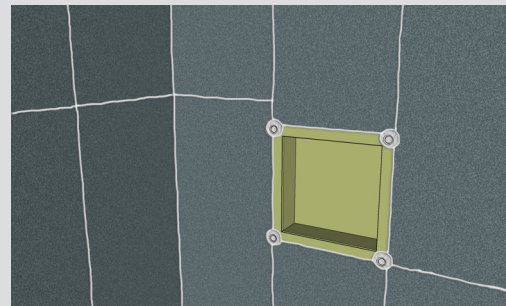

Step 6:
Apply AP1000 Aquamox waterproof tape over all screw heads & wall board/niches joints.



aquamox

0800 404042
sales@crestshowers.co.nz
aquamox.co.nz