

aquamox

Installation Instructions

Tile Over Base - Channel Waste

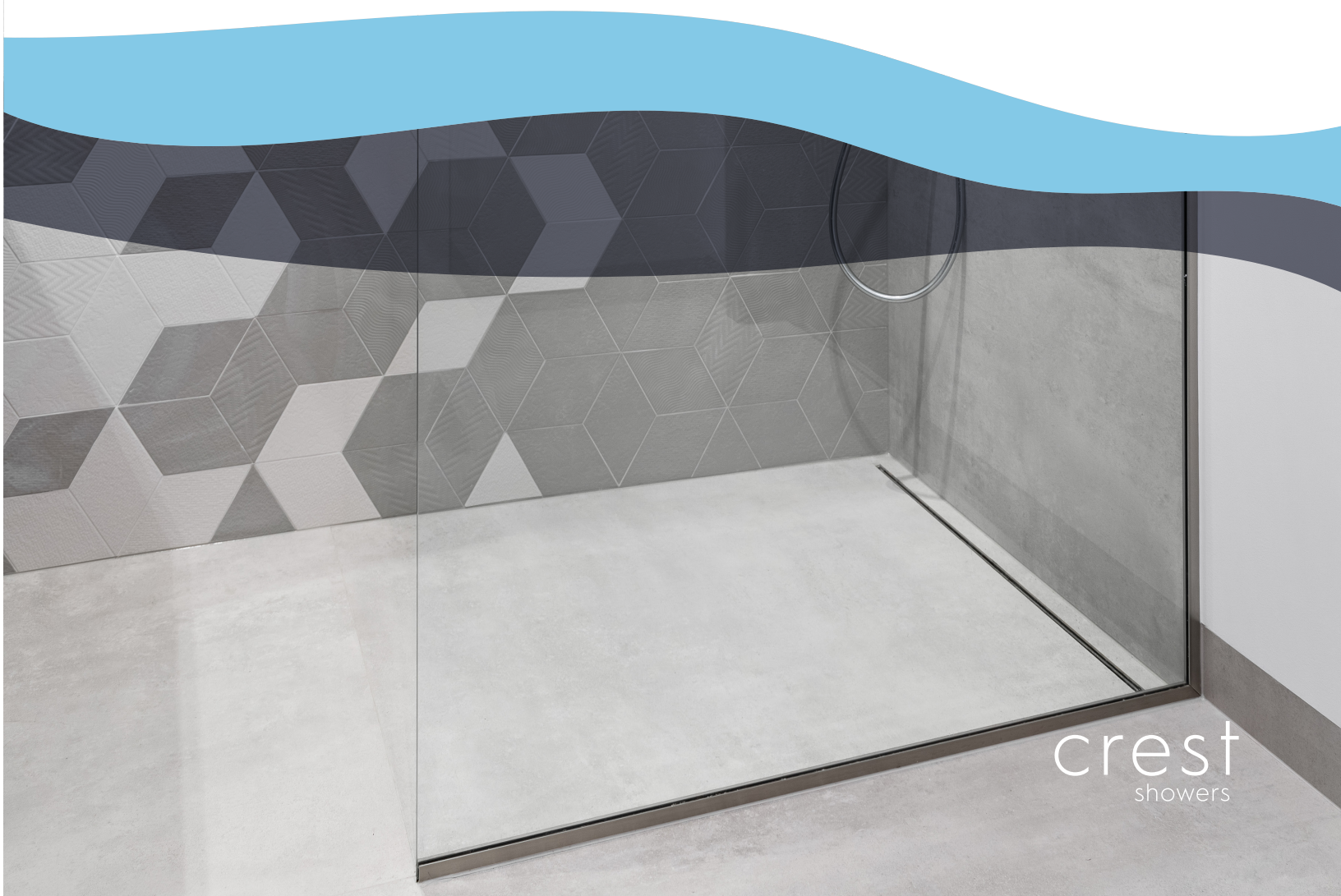

Before You Start

Tools Required

- Caulking Gun
- Level
- Measuring Tape
- Putty Knife
- Builders Pencil
- Circular Saw, Box Knife

! **DO NOT** use solvent based glue (we recomend using Aquamox AP1070)



Preperation

- Ensure that the floor area is clean and free of dust to ensure adhesion
- Check that the waste flange is flush with the floor surface and not proud.
- Check the floor is level. Underlay may be required for a timber floor

- !**
- Aquamox is not suitable for vinyl.
 - Tiles smaller than 50x50mm are not suitable due to point load pressure.
 - Shower base must not be placed directly on floor joists and requires a consistant flat surface

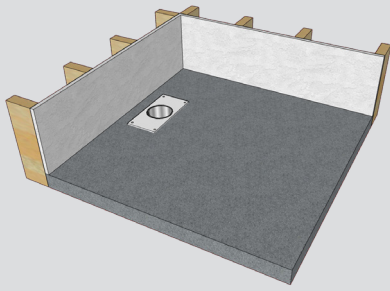

Step 1:
Measure up and mark out the desired location of the shower tray and hobs with a pencil. Check the level of the floor within the shower area and clean the space.

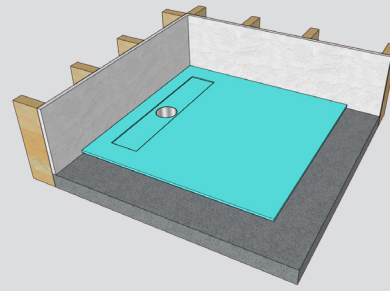

Step 2:
Mark the measurements on the shower tray allowing for the exact location of the waste and shower hobs and then cut to size. Dry fit the shower tray in position and ensure no overhang above the waste. Trim this with a box knife if required.

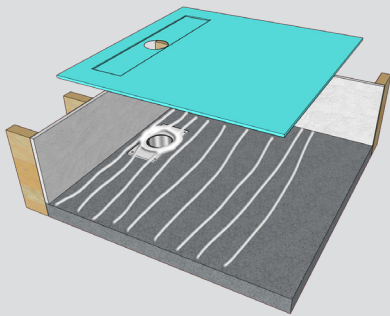

Step 3:
Apply a liberal continuous bead around the top of the flange then apply 8mm parallel beads of the Aquamox AP1070 adhesive to the floor area in 60mm spacing's. Also add a continuous bead of adhesive to the bottom edge of the wall lining of framing at which the tray will meet the walls.

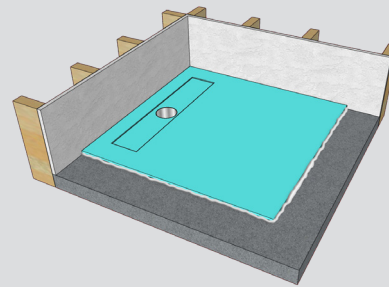

Step 4:
Place the tray on the floor and push against the wall linings. Then apply even pressure to the top of the shower tray to spread the adhesive. Using your finger or a putty knife tool any excess adhesive into the joints or voids.

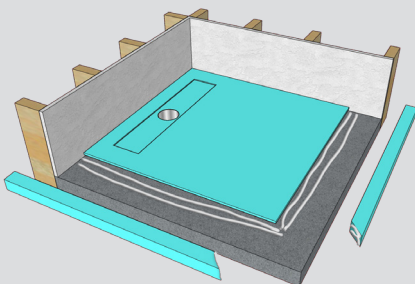

Step 5:
Measure and mark the hob on the inside edge where the tray finishes. Miter cut the hobs for corner showers. Apply 2 parallel beads of adhesive to the floor and on the inside face of the hob where it meets the tray. Offer the hob up to the tray and press in place firmly. Tool off any excess adhesive.

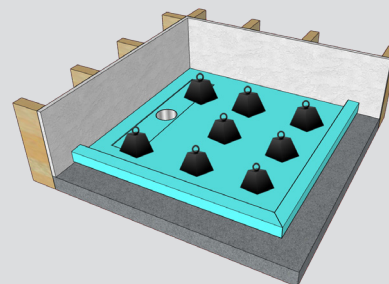

Step 6:
Leave the shower tray for a minimum of 30 minutes to cure, preferably weighted down, before proceeding with waterproofing as per suppliers guidelines & best practices.

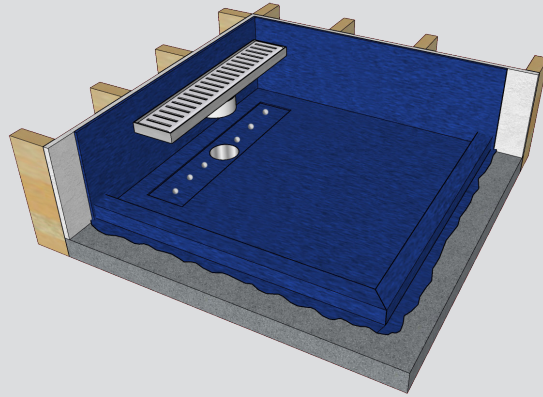

Step 7:

Once the water proofing has cured, the tiler will need to set up the height of the channel waste drain lid to align with the finished surface of the selected tiles. This is achieved by applying large daubs of adhesive under the channel drain to set the finished channel drain height. This is to allow any leakage of water beneath the tiles to be able to work it's way out towards the waste outlet under the channel drain. (A solid mass of adhesive will only trap any water around the channel drain and potentially cause pooling of water.) Position the channel drain on the daubs of adhesive and check the final height is set below the finished tile height. Ensure a 15-20mm clearance is around all sides of the channel drain to accommodate for wall tiles so the removable lid is able to be removed for cleaning.



aquamox

0800 404042
sales@crestshowers.co.nz
aquamox.co.nz